

New Tubular Lugs

- ▶ For Heavy Duty Applications: Trucks, Buses, Forklifts, Automotive, Industrial Equipment
- ▶ Annealed Terminals for Easy Crimping
- ▶ Seamless Barrels for Secure and Accurate Crimp
- ▶ Made from High Quality Copper: 110 Cu ASTM B152

Tubular Lugs – Tin Plated

Available non-plated (delete "" from part number - i.e. ""

Available with sight hole (add "S" before "76" in part number - i.e. "1523TS76"



PART NUMBER	WIRE SIZE	STUD SIZE	DIMENSIONS								MATERIAL THICKNESS	AMPS
			STUD DIA. D	TONGUE WIDTH B	STUD CLEARANCE C2	LGTH. L	BARREL I.D. D1	BARREL O.D. B1	BARREL LGTH. I			
1701T76	8 AWG	1/4	.260	0.465	.375	1.130	.186	.250	.270	.050	70	
1702T76	8 AWG	5/16	.325	0.465	.375	1.130	.186	.250	.270	.050	70	
1703T76	8 AWG	3/8	.400	0.465	.375	1.130	.186	.250	.270	.050	70	
1601T76	6 AWG	1/4	.260	0.540	.390	1.320	.232	.307	.425	.060	95	
1602T76	6 AWG	5/16	.325	0.540	.390	1.320	.232	.307	.425	.060	95	
1603T76	6 AWG	3/8	.400	0.540	.390	1.320	.232	.307	.425	.060	95	
1604T76	6 AWG	1/2	.515	0.670	.350	1.320	.232	.307	.425	.060	95	
1590T76	4 AWG	10	.200	0.545	.390	1.370	.286	.376	.450	.075	125	
1591T76	4 AWG	1/4	.260	0.545	.390	1.370	.286	.376	.450	.075	125	
1592T76	4 AWG	5/16	.325	0.545	.390	1.370	.286	.376	.450	.075	125	
1593T76	4 AWG	3/8	.400	0.545	.390	1.370	.286	.376	.450	.075	125	
1594T76	4 AWG	1/2	.515	0.670	.350	1.370	.286	.376	.450	.065	125	
1580T76	2 AWG	1/4	.260	0.650	.410	1.610	.336	.437	.500	.100	170	
1581T76	2 AWG	5/16	.325	0.650	.410	1.610	.336	.437	.500	.100	170	
1582T76	2 AWG	3/8	.400	0.650	.410	1.610	.336	.437	.500	.100	170	
1583T76	2 AWG	1/2	.515	0.750	.365	1.610	.336	.437	.500	.090	170	
1560T76	1 AWG	1/4	.260	0.645	.425	1.550	.360	.460	.500	.110	170	
1561T76	1 AWG	5/16	.325	0.645	.425	1.550	.360	.460	.500	.110	170	
1562T76	1 AWG	3/8	.400	0.675	.425	1.550	.360	.460	.500	.095	170	
1563T76	1 AWG	1/2	.515	0.750	.365	1.550	.360	.460	.500	.090	170	
1550T76	1/0 AWG	1/4	.260	0.745	.375	1.840	.410	.510	.625	.100	230	
1551T76	1/0 AWG	5/16	.325	0.745	.375	1.840	.410	.510	.625	.100	230	
1552T76	1/0 AWG	3/8	.400	0.745	.417	1.840	.410	.510	.625	.100	230	
1553T76	1/0 AWG	1/2	.515	0.745	.417	1.840	.410	.510	.625	.100	230	
1540T76	2/0 AWG	1/4	.260	0.825	.475	2.045	.460	.560	.650	.100	265	
1541T76	2/0 AWG	5/16	.325	0.825	.475	2.045	.460	.560	.650	.100	265	
1542T76	2/0 AWG	3/8	.400	0.825	.475	2.045	.460	.560	.650	.100	265	
1543T76	2/0 AWG	1/2	.515	0.825	.475	2.045	.460	.560	.650	.100	265	
1531T76	3/0 AWG	5/16	.325	0.910	.500	2.240	.510	.620	.675	.120	310	
1532T76	3/0 AWG	3/8	.400	0.910	.500	2.240	.510	.620	.675	.120	310	
1533T76	3/0 AWG	1/2	.515	0.910	.500	2.240	.510	.620	.675	.120	310	
1520T76	4/0 AWG	1/4	.260	1.000	.515	2.290	.559	.678	.700	.125	360	
1521T76	4/0 AWG	5/16	.325	1.000	.515	2.290	.559	.678	.700	.125	360	
1522T76	4/0 AWG	3/8	.400	1.000	.515	2.290	.559	.678	.700	.125	360	
1523T76	4/0 AWG	1/2	.515	1.000	.515	2.290	.559	.678	.700	.125	360	

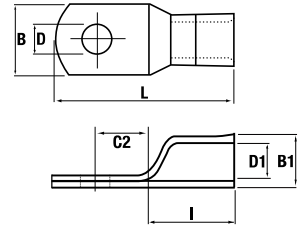

Tubular Lugs – Color Coded Tin Plated with Sight Hole

PART NUMBER	WIRE SIZE	COLOR CODE	DIMENSIONS								MATERIAL THICKNESS
			STUD SIZE	STUD DIA. D	TONGUE WIDTH B	STUD CLEARANCE C2	LGTH. L	BARREL I.D. D1	BARREL O.D. B1	BARREL LGTH. I	
TLS8576	8 AWG	RED	10	.200	0.465	.375	1.130	.186	.250	.270	.050
TLS8676	8 AWG	RED	1/4	.260	0.465	.375	1.130	.186	.250	.270	.050
TLS8876	8 AWG	RED	5/16	.325	0.465	.375	1.130	.186	.250	.270	.050
TLS8976	8 AWG	RED	3/8	.400	0.465	.375	1.130	.186	.250	.270	.050
TLS6676	6 AWG	BLUE	1/4	.260	0.540	.390	1.320	.232	.307	.425	.060
TLS6876	6 AWG	BLUE	5/16	.325	0.540	.390	1.320	.232	.307	.425	.060
TLS6976	6 AWG	BLUE	3/8	.400	0.540	.390	1.320	.232	.307	.425	.060
TLS4676	4 AWG	GREY	1/4	.260	0.545	.390	1.370	.286	.376	.450	.075
TLS4876	4 AWG	GREY	5/16	.325	0.545	.390	1.370	.286	.376	.450	.075
TLS4976	4 AWG	GREY	3/8	.400	0.545	.390	1.370	.286	.376	.450	.075
TLS2676	2 AWG	BROWN	1/4	.260	0.650	.410	1.610	.336	.437	.500	.100
TLS2876	2 AWG	BROWN	5/16	.325	0.650	.410	1.610	.336	.437	.500	.100
TLS2976	2 AWG	BROWN	3/8	.400	0.650	.410	1.610	.336	.437	.500	.100

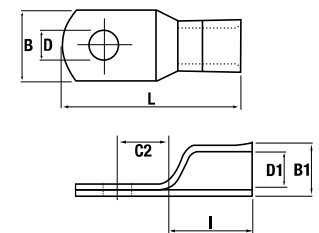

Continued on back



HOFFMAN PRODUCTS
A TPC WIRE & CABLE CORP. BRAND

9600 Valley View Road, Macedonia, Ohio 44056
1-800-645-2014 216-525-4320 FAX 866-896-3017
www.hoffmanproducts.com sales@hoffmanproducts.com

New Tubular Lugs

Tubular Lugs – Color Coded Tin Plated with Sight Hole *(continued)*

PART NUMBER	WIRE SIZE	COLOR CODE	STUD SIZE	DIMENSIONS							MATERIAL THICKNESS
				STUD DIA. D	TONGUE WIDTH B	STUD CLEARANCE C2	LGTH. L	BARREL I.D. D1	BARREL O.D. B1	BARREL LGTH. I	
TLS1676	1 AWG	GREEN	1/4	.260	0.645	.425	1.550	.360	.460	.500	.110
TLS1876	1 AWG	GREEN	5/16	.325	0.645	.425	1.550	.360	.460	.500	.110
TLS1976	1 AWG	GREEN	3/8	.400	0.675	.425	1.550	.360	.460	.500	.110
TLS1/0876	1/0 AWG	PINK	5/16	.325	0.745	.375	1.840	.410	.510	.625	.100
TLS1/0976	1/0 AWG	PINK	3/8	.400	0.745	.417	1.840	.410	.510	.625	.100
TLS1/01376	1/0 AWG	PINK	1/2	.515	0.745	.417	1.840	.410	.510	.625	.100
TLS2/0676	2/0 AWG	BLACK	1/4	.260	0.825	.475	2.045	.460	.560	.650	.100
TLS2/0876	2/0 AWG	BLACK	5/16	.325	0.825	.475	2.045	.460	.560	.650	.100
TLS2/0976	2/0 AWG	BLACK	3/8	.400	0.825	.475	2.045	.460	.560	.650	.100
TLS2/01376	2/0 AWG	BLACK	1/2	.515	0.825	.475	2.045	.460	.560	.650	.100
TLS3/0876	3/0 AWG	ORANGE	5/16	.325	0.910	.500	2.240	.510	.620	.675	.120
TLS3/0976	3/0 AWG	ORANGE	3/8	.400	0.910	.500	2.240	.510	.620	.675	.120
TLS3/01376	3/0 AWG	ORANGE	1/2	.515	0.910	.500	2.240	.510	.620	.675	.120
TLS4/0976	4/0 AWG	PURPLE	3/8	.400	1.000	.515	2.290	.559	.678	.700	.125
TLS4/01376	4/0 AWG	PURPLE	1/2	.515	1.000	.515	2.290	.559	.678	.700	.125

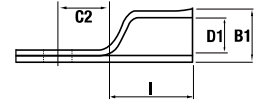
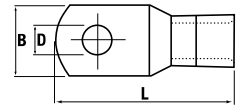

Square Tongue Tubular Lugs – Single Hole *Available in 2 hole version - contact sales@hoffmanproducts.com*

PART NUMBER	WIRE SIZE	COLOR CODE	STUD SIZE	DIMENSIONS							MATERIAL THICKNESS
				STUD DIA. D	TONGUE WIDTH B	STUD CLEARANCE C2	LGTH. L	BARREL I.D. D1	BARREL O.D. B1	BARREL LGTH. I	
STLS8576	8 AWG	RED	10	.200	0.47	0.34	1.30	0.181	0.281	0.44	0.09
STLS8676	8 AWG	RED	1/4	.260	0.47	0.34	1.30	0.181	0.281	0.44	0.09
STLS8876	8 AWG	RED	5/16	.335	0.47	0.34	1.30	0.181	0.281	0.44	0.09
STLS8976	8 AWG	RED	3/8	.400	0.47	0.34	1.30	0.181	0.281	0.44	0.09
STLS6676	6 AWG	BLUE	1/4	.260	0.52	0.38	1.80	0.214	0.312	0.81	0.09
STLS6976	6 AWG	BLUE	3/8	.400	0.52	0.38	1.80	0.214	0.312	0.81	0.09
STLS4676	4 AWG	GRAY	1/4	.260	0.58	0.38	1.80	0.286	0.375	0.81	0.09
STLS4876	4 AWG	GRAY	5/16	.335	0.58	0.38	1.80	0.286	0.375	0.81	0.09
STLS4976	4 AWG	GRAY	3/8	.400	0.58	0.38	1.80	0.286	0.375	0.81	0.09
STLS2676	2 AWG	BROWN	1/4	.260	0.68	0.45	1.88	0.302	0.420	0.88	0.09
STLS2876	2 AWG	BROWN	5/16	.350	0.68	0.45	1.94	0.302	0.420	0.88	0.09
STLS2976	2 AWG	BROWN	3/8	.400	0.68	0.45	2.07	0.302	0.420	0.88	0.09
STLS1676	1 AWG	GREEN	1/4	.260	0.68	0.45	2.10	0.360	0.460	0.88	0.09
STLS1876	1 AWG	GREEN	5/16	.350	0.68	0.45	2.10	0.360	0.460	0.88	0.09
STLS1976	1 AWG	GREEN	3/8	.400	0.68	0.45	2.10	0.360	0.460	0.88	0.09
STLS1/0876	1/0 AWG	PINK	5/16	.350	0.75	0.42	2.10	0.410	0.510	0.88	0.09
STLS1/0976	1/0 AWG	PINK	3/8	.400	0.75	0.42	2.10	0.410	0.510	0.88	0.09
STLS1/01376	1/0 AWG	PINK	1/2	.525	0.75	0.55	2.40	0.410	0.510	0.88	0.09
STLS2/0676	2/0 AWG	BLACK	1/4	.260	0.88	0.55	2.55	0.460	0.560	0.94	0.10
STLS2/0876	2/0 AWG	BLACK	5/16	.350	0.88	0.55	2.55	0.460	0.560	0.94	0.10
STLS2/0976	2/0 AWG	BLACK	3/8	.400	0.88	0.55	2.55	0.460	0.560	0.94	0.10
STLS2/01376	2/0 AWG	BLACK	1/2	.525	0.88	0.55	2.55	0.460	0.560	0.94	0.10
STLS3/0876	3/0 AWG	ORANGE	5/16	.350	0.94	0.55	2.60	0.510	0.620	0.94	0.11
STLS3/0976	3/0 AWG	ORANGE	3/8	.400	0.94	0.55	2.60	0.510	0.620	0.94	0.11
STLS3/01376	3/0 AWG	ORANGE	1/2	.525	0.94	0.55	2.60	0.510	0.620	0.94	0.11
STLS4/0976	4/0 AWG	PURPLE	3/8	.400	1.02	0.55	2.60	0.560	0.680	1.00	0.11
STLS4/01376	4/0 AWG	PURPLE	1/2	.525	1.02	0.55	2.60	0.560	0.680	1.00	0.11
STLS300976	300 MCM	YELLOW	3/8	.400	1.10	0.55	2.80	0.625	0.760	1.06	0.15
STLS3001376	300 MCM	YELLOW	1/2	.535	1.10	0.55	2.80	0.625	0.760	1.06	0.15
STLS3001676	300 MCM	YELLOW	5/8	.655	1.10	0.66	3.00	0.625	0.860	1.06	0.15
STLS350976	350 MCM	RED	3/8	.400	1.30	0.55	3.00	0.725	0.900	1.15	0.18
STLS3501376	350 MCM	RED	1/2	.535	1.30	0.55	3.00	0.725	0.900	1.15	0.18
STLS3501676	350 MCM	RED	5/8	.655	1.30	0.66	3.00	0.725	0.900	1.15	0.18
STLS500976	500 MCM	BROWN	3/8	.400	1.52	0.55	3.60	0.875	1.060	1.40	0.18
STLS5001376	500 MCM	BROWN	1/2	.535	1.52	0.55	3.60	0.875	1.060	1.40	0.18
STLS5001676	500 MCM	BROWN	5/8	.655	1.52	0.66	3.60	0.875	1.060	1.40	0.18
STLS7501376	750 MCM	BLACK	1/2	.535	1.90	0.88	3.75	1.060	1.310	1.90	0.27
STLS7501676	750 MCM	BLACK	5/8	.655	1.90	0.88	3.75	1.060	1.310	1.90	0.27
STLS10001376	1000 MCM	WHITE	1/2	.535	2.15	0.88	5.80	1.200	1.500	3.00	0.33
STLS10001676	1000 MCM	WHITE	5/8	.655	3.15	0.88	5.80	1.200	1.500	3.00	0.33

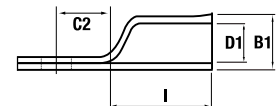
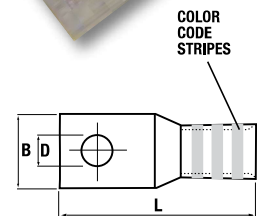

HOFFMAN PRODUCTS
A TPC WIRE & CABLE CORP. BRAND

WARRANTY & DISCLAIMER: There are no express warranties which extend beyond the description on the face hereof. Seller disclaims any implied warranties of merchantability or of fitness for any particular purpose. Since seller cannot control the manner or use of its products after their sale, Seller will not be responsible for any indirect or consequential damages. Seller, will, at its option either replace the products sold or refund the purchase price. No warranties will apply if products are in any way altered or modified after delivery by seller.

HOF117 (REV. 9/12) PRINTED IN U.S.A. ©Copyright 2012 All rights reserved.